

1. Mechanical Dimensions:

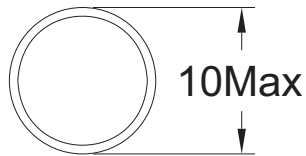

(TOP VIEW)

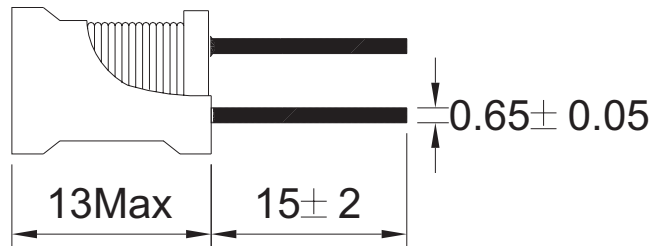

(SIDE VIEW)

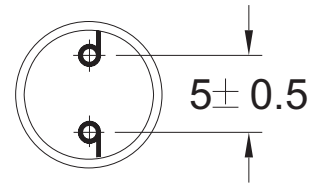

(BUTTON VIEW)

2. Electrical Characteristics :

Specifications: at 25°C . Operating Temperature -40 to +85°C

| NO. | ITEM | TEST CONDITION | SPECIFICATION |
|-----|------------|---------------------|---------------|
| 1 | Inductance | (1-2)@1KHz, 0.25Vac | 1mH+/-20% |
| 2 | DCR | (1-2) @ 25°C | 1.9Ω Max |

3. SCHEMATIC:

